

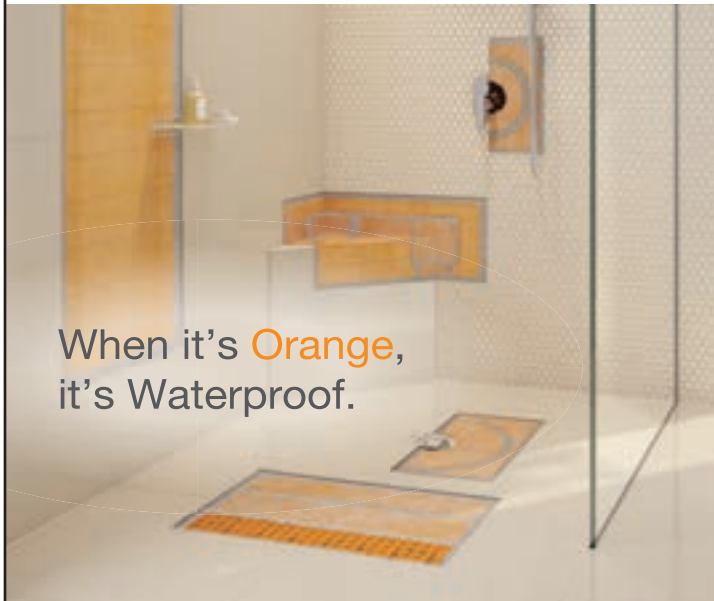



Schluter®-Shower System

Complete waterproofing system for tiled showers



When it's **Orange**,
it's Waterproof.

Mary E. Yocum

Architectural Manager, Southern CA
714-329-0355 | myocum@schluter.com
www.schluter.com

PITTSBURGH PAINTS CO.



Susan L. Giampietro
Architect & Design Manager- California
949-410-2452
Giampietro@peg.com

Lisa Fyke
CSI, AIAOC - Allied Member
Architectural Representative
lfyke@mapei.com
Cell: (909) 247-5324



MAPEI Corporation
5415 North Industrial Parkway, San Bernardino, CA 92407
Website: www.mapei.com

Stephen Bellingham | CSI, CDT
Architectural Services Consultant | Allegion
Irvine, CA

E: stephen.bellingham@allegion.com
T: 949-543-9514
w: us.allegion.com/design



BRIGHTWHITE

ROOFING MEMBRANES & COATINGS

ENERGY SAVINGS START AT THE TOP

Maximize Reflectivity & Roof Lifespan

High-SRI Formulas Deliver:

-  Extended Roof Performance
-  Codes Compliance
-  Energy Savings

Explore our Kool Roof Solutions®



POLYGLASS.US

Kool Roof Solutions



POLYGLASS
MAPEI GROUP

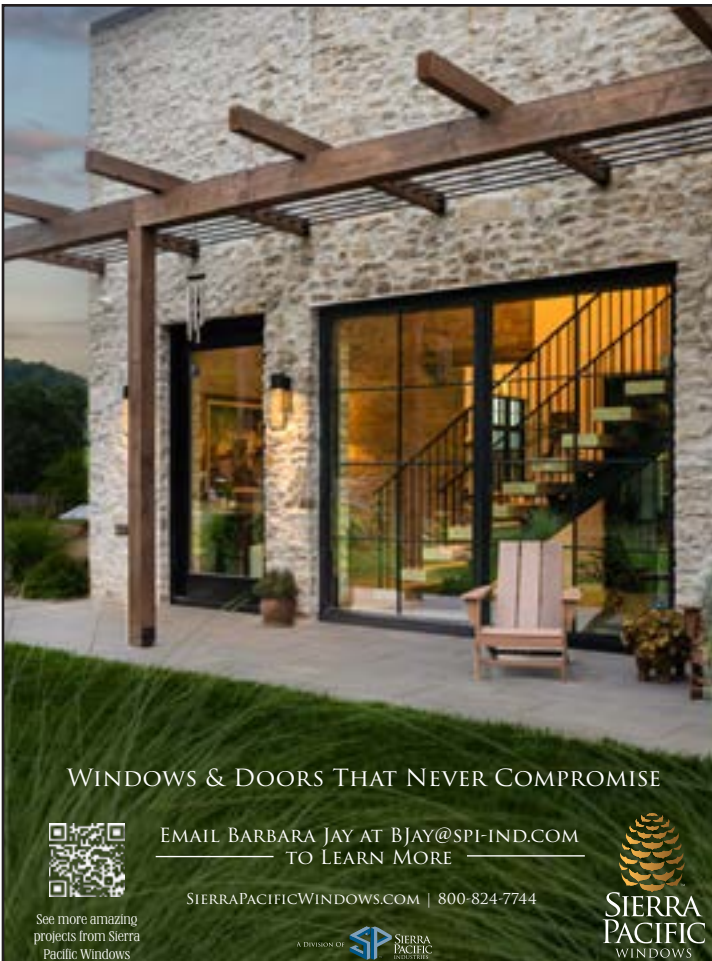

WINDOWS & DOORS THAT NEVER COMPROMISE



EMAIL BARBARA JAY AT BJAY@SPI-IND.COM
TO LEARN MORE

SIERRAPACIFICWINDOWS.COM | 800-824-7744



See more amazing projects from Sierra Pacific Windows

A DIVISION OF  SIERRA PACIFIC WINDOWS

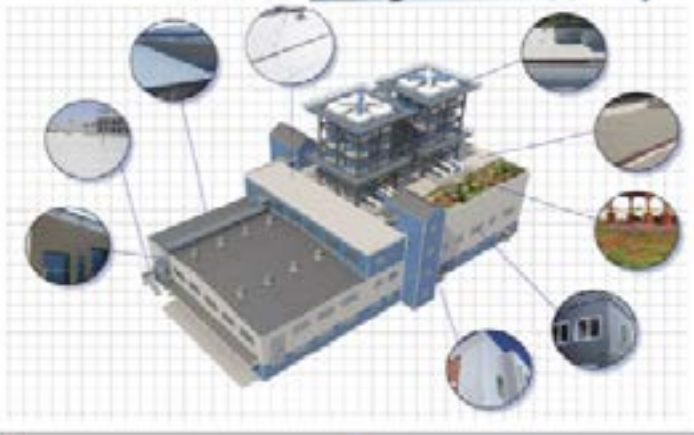

- Roof & Wall Cladding Systems
- Roof Membranes
- Air Barrier Systems
- Plaza and Roof Decks
- Vegetative Roof Systems
- Flooring and Floor Protection
- Sound Management Barriers
- Coatings, Mastics, Sealants & Adhesives

BUILDING ENVELOPE SOLUTIONS



Alex Zywicki
azywicki@garlandco.com
(480) 459-1119
www.garlandco.com

Frank Saldana ,CIA, CSI, CDT®, LEED Green Associate
Building Development Manager



14213 Whittram Avenue
Fontana CA 92335
Office Phone: 909.829.8618
Office Fax: 909.829.9083
Cell Phone: 840.217.1270
www.metalsales.us.com

 FACEBOOK |  TWITTER |  LINKEDIN |  YOUTUBE



APPLY A HIGHER STANDARD™



Kim Hampton

Architectural Services Representative

CSI / Allied AIA / Allied ASID

C. (949) 576-8835 E. Kim.Hampton@DunnEdwards.com

16191 Lake Forest Dr., Irvine, CA 92618

dunnedwards.com



Lola Wilson
ARCHITECTURAL / CONTRACTOR REPRESENTATIVE

MOBILE 949.545.1360

1395 North Grandview Hwy.
Vancouver, BC, V5N 1N2

lola.wilson@clarkdietrich.com



**POLYCOAT
PRODUCTS**

A Division of American Polymers Corp.

Brandon Carpenter
Regional Manager

13827 Carmenita Road, Ste 200, Santa Fe Springs, CA 90670

Cell: (562) 837-6621

E: brandon@polycoatusa.com



Entrances | Storefront | Curtain Wall
Window Wall | Balcony Doors | Windows | Sun Control

www.ykkap.com